

RESIDENTIAL AND INDUSTRIAL DOOR SYSTEMS

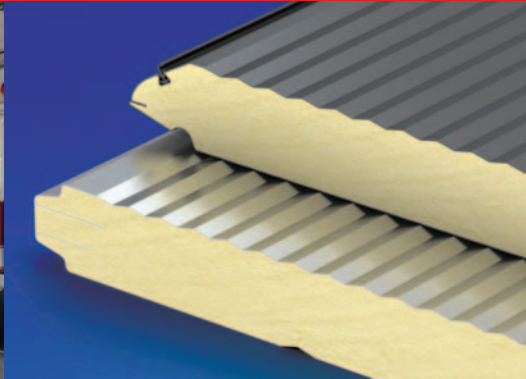

Insulated Door Panel Price List July 2010



Kingspan Door Components

Residential Panels

Residential MR Panel

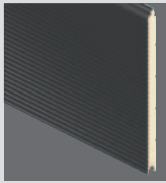

Residential RT Panel



Residential RL Panel

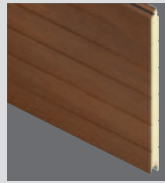

Residential RC Panel



Residential RF Panel

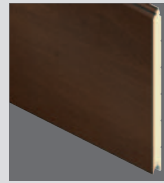

Residential RS Panel



Residential RV Panel

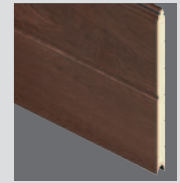

Residential Hardware

EasyClick 200 Installation Kit

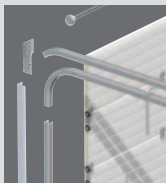

EasyClick 70 Installation Kit

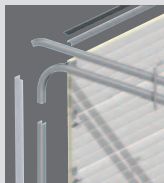

EasyClick 70 Renovation Installation Kit

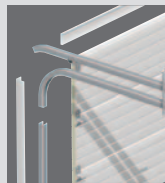

Burglar Resistant Hardware



EasyPass Installation Kit



Industrial Panels

Industrial IL Panel

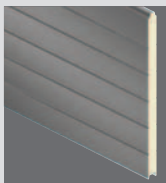

Industrial MR Panel



Industrial 80 mm Panel

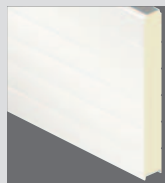

Industrial Aluminium Panel



Kingspan Vista

Kingspan Vista Panel



Kingspan Full Vision Profiles and Components



Industrial Hardware

Cables and Pulleys



Springs and Accessories

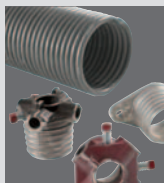

Hinges and Rollers

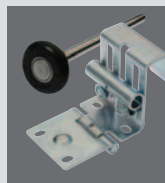

Profiles and Bolts



Locks and Handles



Kingspan Door Components

Zone Industrielle de l'Europe 1A, 7900 Leuze-en-Hainaut, Belgium
 General Telephone: +32-69-45.24.60 Fax: +32-69-86.82.20 Email: info@kingspandoor.com

www.kingspandoor.com

Due to our continuing policy of development and improvement, we reserve the right to alter and amend the specifications shown in this literature. All dimensions are nominal. We make every effort to ensure perfect colour reproduction, but owing to printing limitations, the colours shown may not match exactly. Actual product samples should be obtained from your panel supplier.

Tariff Price List

Update: July 2010



40mm Industrial Panels. Fingersafe and Traditional Polyester painted Steel Panels

Stucco Embossed IL

Height mm	Facing	Colour	Price List EUR/m ² July 2010
500	Polyester	RAL 9010	29,79
500	Polyester	RAL7016/7042/9006/9007 +	30,53
500	Polyester	All other colours*	29,79
610	Polyester	RAL 9010	29,16
610	Polyester	RAL7016/7042/9006/9007 +	29,88
610	Polyester	All other colours*	29,16

Micro-Rib MR

Height mm	Facing	Colour	Price List EUR/m ² July 2010
500	Polyester	RAL 9010	30,79
500	Polyester	RAL7016/7042/9006/9007 +	31,53
500	Polyester	All other colours*	30,79
610	Polyester	RAL 9010	30,16
610	Polyester	RAL7016/7042/9006/9007 +	30,88
610	Polyester	All other colours*	30,16

Plastisol painted Steel Panels

Height mm	Facing	Colour	Price List EUR/m ² July 2010
610	XL200 Plastisol	All Standard KDC Colours	47,54

Aluminium Panels

Traditional Joint Only

Height mm	Thickness	Colour	Price List EUR/m ² July 2010
610	40	Mill Finish Aluminium	36,60

80mm Polyester painted Steel Panels

Traditional Joint Only

Height mm	Facing	Colour	Price List EUR/m ² July 2010
610	Polyester	RAL 9010/9002	41,24

* RAL 1021, 3000, 5010, 6005, 8014, 9002

Tariff Price List

Update: July 2010



40mm Residential Panels with Fingersafe joint Polyester painted and PVC Oak film Steel Panels

RL and RF PANELS

Height mm	Colour	Price List EUR/m ² July 2010
500	RAL9010	31,30
500	RAL 7016+/7023/7039	33,79
500	All other colours*	32,88
500	Oak panels**	37,19
500	Natural oak	39,19
500	Polygrain Flat	41,24
610	RAL9010	30,84
610	RAL 7016+/7023/7039	33,29
610	All other colours*	32,39
610	Oak panels**	36,22
610	Natural oak	38,22
610	Polygrain Flat	40,50

CASSETTES STEEL PANELS

Height mm	Colour	Price List EUR/m ² July 2010
500	RAL9010	31,30
500	All other colours*	32,88
500	Oak panels**	38,80
500	Natural oak	40,80
610	RAL9010	30,84
610	All other colours*	32,39
610	Oak panels**	37,78
610	Natural oak	39,78

RV/RS/RT STEEL PANELS

Height mm	Colour	Price List EUR/m ² July 2010
500	RAL9010	31,30
500	RAL 7016+/7023/7039	33,79
500	All other colours*	32,88
500	Oak panels**	38,80
500	Natural oak	40,80
500	Polygrain Flat	41,24
610	RAL9010	30,84
500	RAL 7016+/7023/7039	33,29
610	All other colours*	32,39
610	Oak panels**	37,78
610	Natural oak	39,78
610	Polygrain Flat	40,50

* RAL1015, 6005, 8014, 9016

** luxe oak, dark oak, rustic oak, mahogany